

C6 HARNESS MOUNT BAR
INSTALLATION INSTRUCTIONS

Fits '05-'13 C6 coupes & '06-'13 Z06 coupes

The R-1120 Harness Mount Bar has been designed and tested to provide a mounting point for the shoulder harness portion of a five point harness in C6 coupe and Z06 coupe model Corvettes. To mount the lap belts order BK part number R-9120 lap belt mounting kit. Installation takes approx. 6 hours.

Step 1

Put Seat into front most position, and unbolt rear seat bolts using 15mm socket. Unplug electrical connector at rear of seat. It is clipped to the seat frame, and can be pulled loose to make removal easier. Pull the two blue tabs out of the connector then pull tongs away from the body of the connector, and pull connector apart. Approximate positions of connector, with seat removed, can be seen in Figure 1.

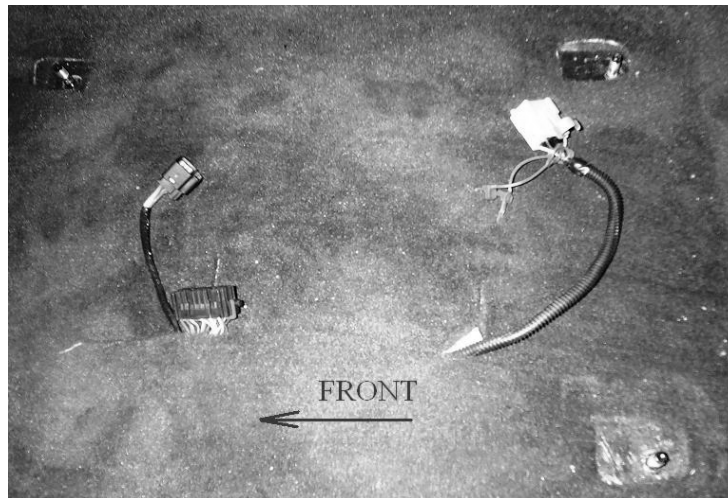

Figure 1

Step 2

Put Seats into rear most position. Remove clips from covers on front seat bolts. It is easiest to pull the center pin up slightly with your fingers then use wire cutters to gently grab center pin and pull up. Be careful not to squeeze too tightly or you will cut pin off.

Step 3

Unbolt front seat bolts using 15mm socket. Unplug electrical connectors at front of seat. To unplug the large plug, push in tongs at back of connector, and rotate purple tab downward, then pull apart. To unplug small plug (only on some models) insert small screwdriver into slot on bottom of connector and pull apart. Approximate positions of connectors, with seat removed, can be seen in Figure 1.

Step 4

The seat can now be lifted slightly to allow removal of shoulder belt retaining nut using 15mm socket, and seat belt electrical connector (only on some models). Remove the seat from the car and repeat for the other side.

Step 5

Remove plastic fasteners, "A" in Figure 2, from rear headliner trim piece, there are two on each side. These just pull out, but be careful they are fragile. Then carefully pull down to disengage clips at both sides and center of panel. See Figure 3a for Z06 locations and Figure 3b for standard C6.



Figure 2

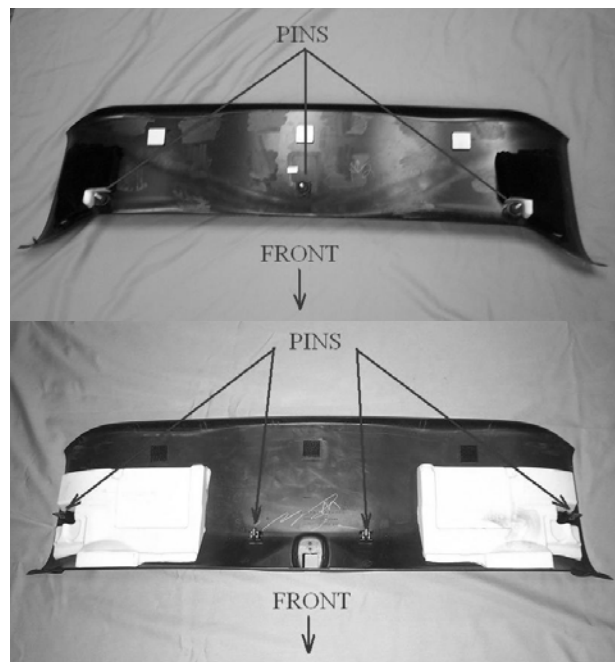

Figure 3a

Figure 3b

Step 6

Pull back boot on lower trunk strut mount, and prop the trunk open or have someone hold it open. Now using a screwdriver pry up on the clip slightly to release strut from ball mount do this for both sides. As shown in Figure 4.



Figure 4

Step 7

Remove plastic fasteners, "B" in Figure 2, from sail panels, and then pull the panels off. There are two spring clips at the front and one at the rear. The two spring clips just pull straight out, then slide the panel to the rear of the car to release from the rear clip. Remove the seat belt trim piece by pushing taps inward, and sliding the piece through the sail panel. The sail panel can now be removed.

Step 8

Remove the upper seat belt mounting bolts using a T47 Torx bit.

Step 9

Place the harness bar brackets in position behind the roll hoop as in Figure 5 (Driver side shown). Using the supplied bolts and spacers, as shown in Figure 6a for Z06 and Figure 6b for standard C6, loosely fasten the bracket to the roll hoop.

****MAKE SURE TO USE THE CORRECT BOLTS. THEY ARE LABELED FOR C6 (COARSE) AND Z06 (FINE).****



Figure 5

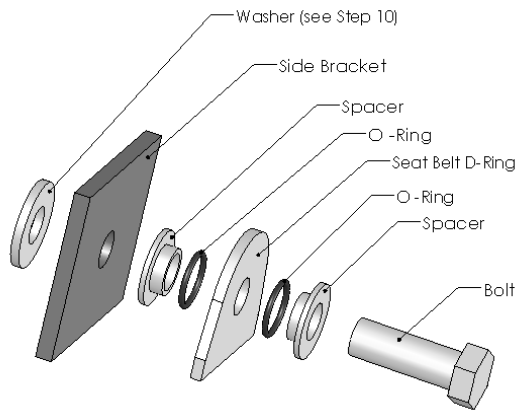

Figure 6a

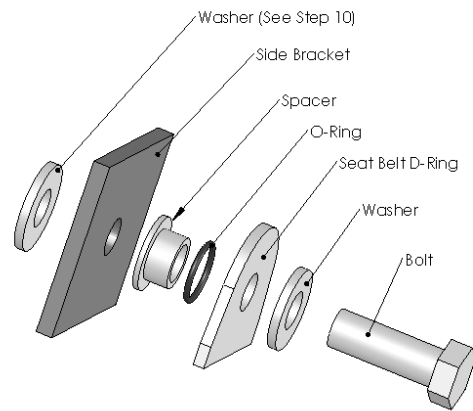

Figure 6b

Step 10

Slide bar onto studs and tighten upper seat belt mounting bolt (using 18mm wrench for standard C6 and 5/8" for Z06. The bar should still be able to slide off the brackets. If the bar is tight on the studs it may be necessary to place a supplied washer behind the side bracket. Once the brackets are tight and the bar is still able to slide if holes do not align or it is not centered, adjust studs in or out so that it is. The four bolts holding the bar to the brackets should be able to slide out of the hole easily. It may take several trials to get this right, be patient. With bar in place tighten and the four through bolts tightened, tighten jam nuts on studs using a 1 1/16" wrench and remove the harness bar.

Step 11

Using supplied templates (positioned as in Figure 7), and a 7/8" hole saw (available at most hardware stores), cut access holes in sail panels. It is best to start saw from back of panel to create a center hole, then apply masking tape around the center hole on the front side and drill from front of panel to make the final hole. Cut away any flashing left from drilling. Cut away corners of foam insulation as shown in Figure 7.

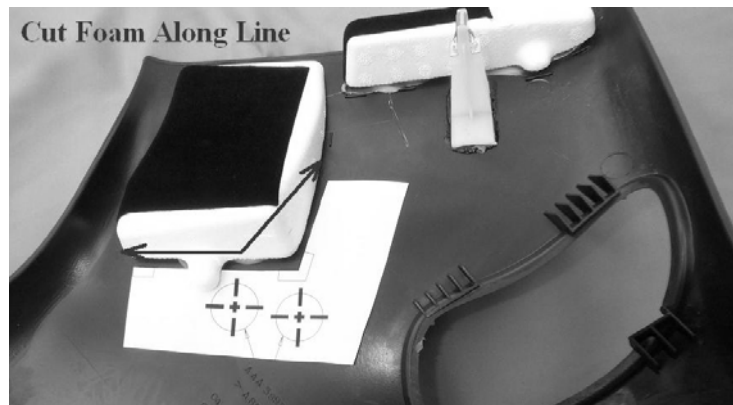

Figure 7

Note: If you would like to keep your original sail panels, replacements can be ordered from your GM Dealer, Part 15277640 for driver side, and 15277641 for passenger side.

Step 12

If the rear sail panel clips remained in the car, remove them and slide them into their slot on the sail panel, as the panel can not be slid with the harness bar mounting studs in place. Reinstall the sail panels.

Step 13

Reinstall the bar and tighten side bolts.

Step 14

Reinstall trunk struts.

Step 15

Reinstall rear headliner trim.

Step 16

Reinstall seats making sure all electrical connectors are connected.

When finished the installation should look similar to below. The harness bar can be removed from the car by simply unbolting it and sliding off the mounting studs. If the bar is to be permanently removed the studs can be removed and the holes in the sail panels can be plugged using the supplied plastic plugs.



Performance driving events are by nature potentially hazardous to your health. Brey-Krause Mfg. Co. Inc. shall not be liable for injury, consequential, or other types of damages resulting from the use or misuse of our products. Proper installation of these parts is critical and should only be done by a professional shop.